

Clamp Adapters

Rubber Hose Adapters - 14MPHR

Fittings

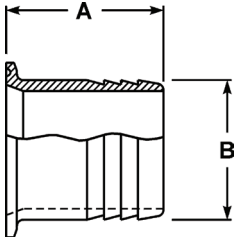

Tube OD	Hose Size	A	B	304 Stainless Steel Part Number	316L Stainless Steel Part Number
1/2"	1/8"	1.250	.125	---	14MPHR-R50125
	1/4"	1.500	.250	---	14MPHR-R5025
	3/8"	1.500	.375	---	14MPHR-R50375
	1/2"	1.500	.500	---	14MPHR-R50
	3/4"	1.500	.750	---	14MPHR-R5075
3/4"	1/8"	1.500	.125	---	14MPHR-R75125
	1/4"	1.500	.250	---	14MPHR-R7525
	3/8"	1.500	.375	---	14MPHR-R75375
	1/2"	1.500	.500	---	14MPHR-R7550
	3/4"	1.500	.750	---	14MPHR-R75
1"	3/8"	1.500	.375	14MPHR-G100375	14MPHR-R100375
	1/2"	1.500	.500	14MPHR-G10050	14MPHR-R10050
	3/4"	1.688	.750	14MPHR-G10075	14MPHR-R10075
	1"	1.688	1.000	14MPHR-G100	14MPHR-R100
1 1/2"	1/8"	1.500	.125	14MPHR-G150125	14MPHR-R150125
	1/4"	1.500	.250	---	14MPHR-R15025
	3/8"	1.500	.375	14MPHR-G150375	14MPHR-R150375
	1/2"	1.500	.500	14MPHR-G15050	14MPHR-R15050
	5/8"	1.500	.625	14MPHR-G150625	14MPHR-R150625
	3/4"	1.500	.750	14MPHR-G15075	14MPHR-R15075
	1"	1.687	1.000	14MPHR-G150100	14MPHR-R150100
	1 1/4"	1.689	1.250	---	14MPHR-R150-125
2"	1 1/2"	2.312	1.500	14MPHR-G200150	14MPHR-R200150
	2"	2.312	2.000	14MPHR-G200	14MPHR-R200
2 1/2"	2 1/2"	2.344	2.500	14MPHR-G250	14MPHR-R250
3"	3"	3.094	3.000	14MPHR-G300	14MPHR-R300
4"	4"	3.406	4.000	14MPHR-G400	14MPHR-R400
6"	6"	3.406	6.000	14MPHR-G600	14MPHR-R600
8"	8"	3.406	8.000	14MPHR-G800	14MPHR-R800

Brewery Hose Barb Adapters - 14MPHRL

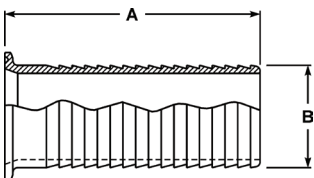

Feature:

- suitable for use with band clamps

Size	A	B	304 Stainless Steel Part Number
1"	3.500	1.045	14MPHRL100
1 1/2"	5.000	1.545	14MPHRL150
2"	5.000	2.045	14MPHRL200
2 1/2"	5.500	2.545	14MPHRL250
3"	5.500	3.045	14MPHRL300
4"	5.500	4.045	14MPHRL400



Use of PVC tubing requires special techniques to prevent leakage. All assembly work must be done with heated tube. Cold durometer is 90 as opposed to rubber hose at 65 to 70 durometer. Banding buckles must be at 180° from one another.